

A0801 SUH CONNECTOR

0.80mm Pitch/Disconnectable Crimp style connectors

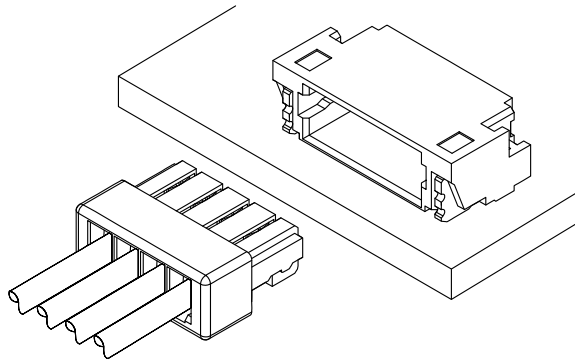

This SUH connector is developed for crimping type SUR connector that has been designed for 0.80 mm pitch wire-to-board insulation displacement connector. This connector adopted the first crimping method in a minimum 0.80mm pitch of the wire-to-board type connector. Housing lance method provides the good workability and a constriction contact method provides the excellent contact reliability.

- Wafer are for common use with A0800 SUR connector.
- Current rating 1.00 A
- Miniaturization

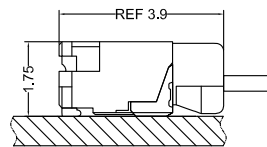
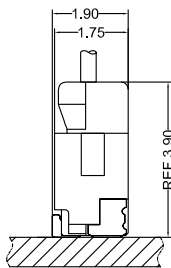

- Note: 1. The above figure is the figure viewed from the connector mounting side.
2. Tolerances are non-cumulative: ± 0.08 mm for all centers.
3. The dimensions above should serve as a guideline. Contact CSG for details.



Specifications:

- Current rating: 1.0 A AC, DC (AWG #28)
 - Voltage rating: 30 V AC/DC
 - Temperature range: $-40^{\circ}\text{C} \sim +105^{\circ}\text{C}$
(including temperature rise in applying electrical current)
 - Contact resistance: Initial value/ 30m Ω max
After environmental testing/ 50m Ω max
 - Insulation resistance: 100 M Ω min
 - Withstanding voltage: 200 VAC/minute
 - Applicable wire: Conductor size/ AWG#32 to #28
Insulation O.D./ 0.5 to 0.6 mm
- * Compliant with RoHS2/ REACH
* Refer to "General Instruction and Notice when using Terminals and Connectors" at the end of this catalog.
* Contact CSG for details

Material:

Housing: PA46, UL94-V0; Color: Gray

Terminal: Phosphor/ Tin-plated, Gold-Plated

CSG

A0801 SUH

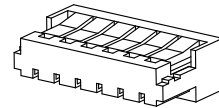
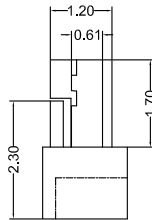
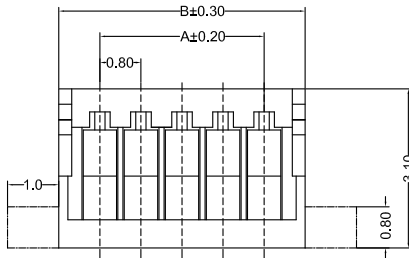
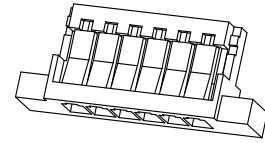
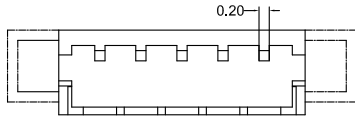

Circuit 1

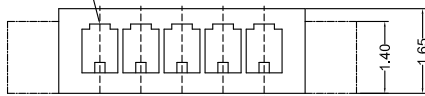

A0801HF 0XX AX XX 8 XXX
 PIN 002=2PINS
 SPECIAL AA=NO Special AB=Protrusions
 Material P4=PA46 94V-0 LP=LCP 94V-0
 Code 001 005 Color 8=Gray

| CSG PART NO. | Dimension mm | | Q'ty/BAG |
|--------------------|--------------|-------|----------|
| | A | B | |
| A0801HF002AXXX8XXX | 0.80 | 2.40 | 1000PCS |
| A0801HF003AXXX8XXX | 1.60 | 3.20 | 1000PCS |
| A0801HF004AXXX8XXX | 2.40 | 4.00 | 1000PCS |
| A0801HF005AXXX8XXX | 3.20 | 4.80 | 1000PCS |
| A0801HF006AXXX8XXX | 4.00 | 5.60 | 1000PCS |
| A0801HF007AXXX8XXX | 4.80 | 6.40 | 1000PCS |
| A0801HF008AXXX8XXX | 5.60 | 7.20 | 1000PCS |
| A0801HF009AXXX8XXX | 6.40 | 8.00 | 1000PCS |
| A0801HF010AXXX8XXX | 7.20 | 8.80 | 1000PCS |
| A0801HF011AXXX8XXX | 8.00 | 9.60 | 1000PCS |
| A0801HF012AXXX8XXX | 8.80 | 10.40 | 1000PCS |
| A0801HF014AXXX8XXX | 10.40 | 12.00 | 1000PCS |
| A0801HF015AXXX8XXX | 11.20 | 12.80 | 1000PCS |
| A0801HF016AXXX8XXX | 12.00 | 13.60 | 1000PCS |
| A0801HF018AXXX8XXX | 13.60 | 15.20 | 1000PCS |
| A0801HF020AXXX8XXX | 15.20 | 16.80 | 1000PCS |

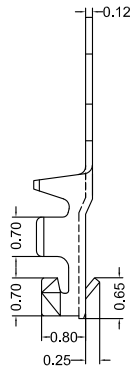
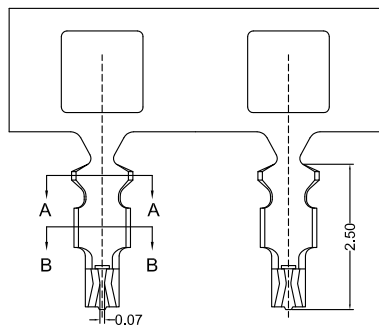

SECTION A-A

SECTION B-B

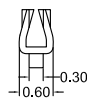

A0801 M 0 Δ XX XXX
 Type M=Female Terminal
 Material A=Phosphor
 Finish TP=TIn-Plated GF=Gold-Plated G/F
 Code 195 001

| CSG PART NO. | Wire Range | Insulation O.D. | Q'ty/Reel |
|---------------|------------|-----------------|-----------|
| A0801M0ATPXXX | AWG#28-#32 | 0.60mm(max) | 30000PCS |
| A0801M0AGFXXX | AWG#28-#32 | 0.60mm(max) | 30000PCS |

