

# A2547 Samtec 2.54 CONNECTOR

2.54mm Pitch/Disconnectable Insulation displacement connectors

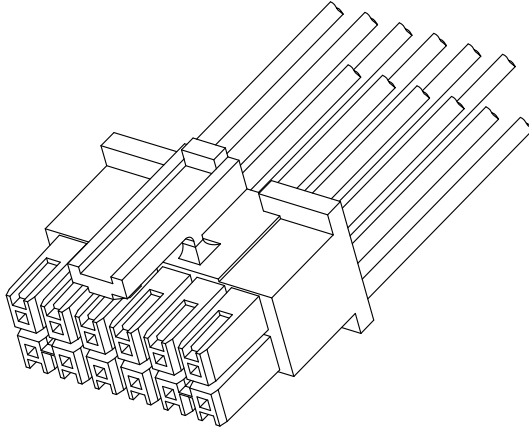

- Secure locking structure
- Low insertion force
- Suction area for picking up
- Improvement of engagement with prying

## Specifications: \_\_\_\_\_

- Current rating: 3.0 A / AC,DC (AWG #20)
- Voltage rating: 250 V AC/DC
- Temperature range: -25°C ~ +105°C  
(including temperature rise in applying electrical current)
- Contact resistance: Initial value/ 30m Ω max  
Insulation resistance: 1000 MΩ min  
Withstanding voltage: 1000 VAC/minute  
Applicable wire: Conductor size/ AWG#24~#20  
Insulation O.D./ 1.30 to 1.85 mm
- \* Compliant with RoHS2/ REACH/ HF
- \* Refer to "General Instruction and Notice when using Terminals and Connectors"
- \* Contact CSG for details

Material: \_\_\_\_\_  
Housing: PA66/UL94-V2;Color:White  
Terminal: Phosphor/ Tin-plated/ Gold-Plated

- Note: 1. The above figure is the figure viewed from the connector mounting side.  
2. Tolerances are non-cumulative: ±0.08 mm for all centers.  
3. The dimensions above should serve as a guideline. Contact CSG for details.

**CSG**

# A2547 Samtec 2.54

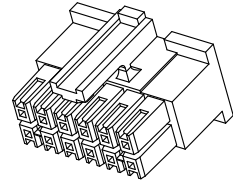
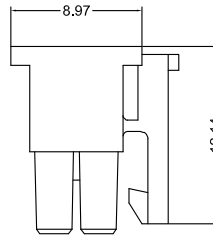
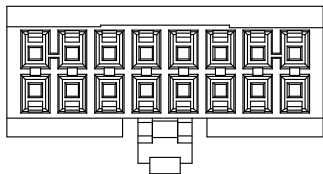
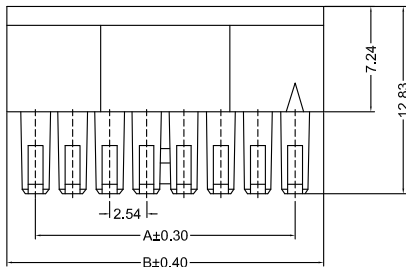
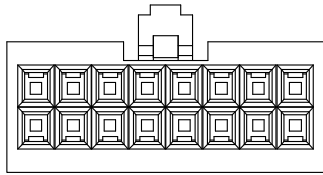

A2547HF 2XX AK P6 X 001  
 PIN  
 205=2X5PINS  
 SPECIAL  
 AK=BUCKLE  
 Material  
 P6=PA66 94V-0

Code  
 001  
 Color  
 9=White

CSG PART NO.	Dimension mm		Q'ty/BAG
	A	B	
A2547HF202AKP69001	2.54	8.26	1000PCS
A2547HF203AKP69001	5.08	10.80	1000PCS
A2547HF204AKP69001	7.62	13.34	1000PCS
A2547HF205AKP69001	10.16	15.88	1000PCS
A2547HF206AKP69001	12.70	18.42	1000PCS
A2547HF207AKP69001	15.24	20.96	1000PCS
A2547HF208AKP69001	17.78	23.50	1000PCS
A2547HF209AKP69001	20.32	26.04	1000PCS
A2547HF210AKP69001	22.86	28.58	1000PCS
A2547HF211AKP69001	25.40	31.12	1000PCS
A2547HF212AKP69001	27.94	33.66	1000PCS
A2547HF213AKP69001	30.48	36.20	1000PCS
A2547HF214AKP69001	33.02	38.74	1000PCS
A2547HF215AKP69001	35.56	41.28	1000PCS
A2547HF216AKP69001	38.10	43.82	1000PCS
A2547HF220AKP69001	48.26	43.98	1000PCS
A2547HF225AKP69001	60.96	66.68	1000PCS

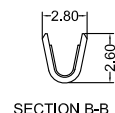
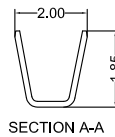
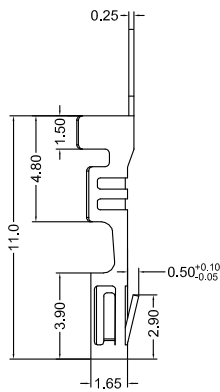
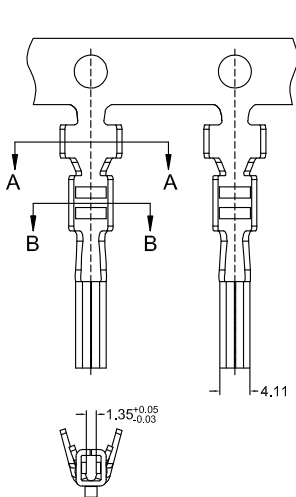

A2547 M 0 A XX 001

Type  
 M=Female Terminal

SPECIAL  
 O=NO Special

Material  
 A=Phosphor

Flnsh  
 TP=Tin-Plated  
 GF=Gold-Plated G/F

Code  
 001

CSG PART NO.	Wire Range	Insulation O.D.	Q'ty/Reel
A2547M0ATP001	AWG#20-#24	1.85mm(max)	10000PCS
A2547M0AGF001	AWG#20-#24	1.85mm(max)	10000PCS

