

# A0801 SUH CONNECTOR

0.80mm Pitch/Disconnectable Crimp style connectors

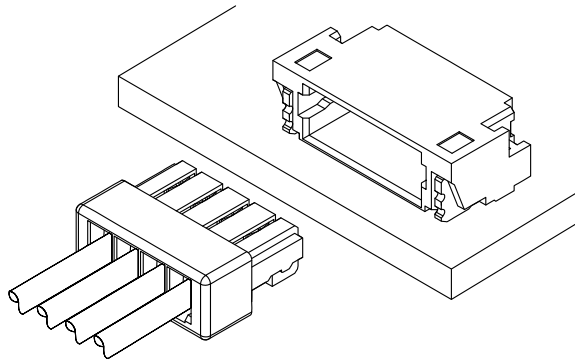

This SUH connector is developed for crimping type SUR connector that has been designed for 0.80 mm pitch wire-to-board insulation displacement connector. This connector adopted the first crimping method in a minimum 0.80mm pitch of the wire-to-board type connector. Housing lance method provides the good workability and a constriction contact method provides the excellent contact reliability.

- Wafer are for common use with A0800 SUR connector.
- Current rating 1.00 A
- Miniaturization



## Specifications:

- Current rating: 1.0 A AC,DC (AWG #28)
  - Voltage rating: 30 V AC/DC
  - Temperature range: -40°C ~ +105°C  
(including temperature rise in applying electrical current)
  - Contact resistance: Initial value/ 30m Ω max  
After environmental testing/ 50m Ω max
  - Insulation resistance: 100 M Ω min
  - Withstanding voltage: 200 VAC/minute
  - Applicable wire: Conductor size/ AWG#32 to #28  
Insulation O.D./ 0.5 to 0.6 mm
- \* Compliant with RoHS2/ REACH  
\* Refer to "General Instruction and Notice when using Terminals and Connectors" at the end of this catalog.  
\* Contact CSG for details

Material:

Housing: PA46,UL94-V0;Color:Gray

Terminal: Phosphor/ Tin-plated, Gold-Plated

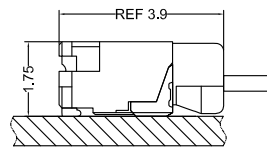
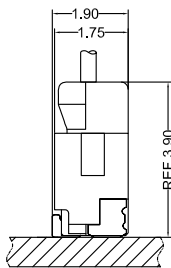

- Note: 1. The above figure is the figure viewed from the connector mounting side.  
2. Tolerances are non-cumulative:  $\pm 0.08$  mm for all centers.  
3. The dimensions above should serve as a guideline. Contact CSG for details.

**CSG**

# A0801 SUH

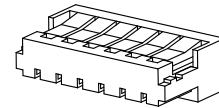
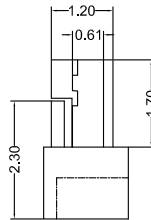
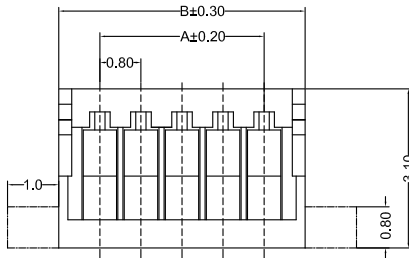
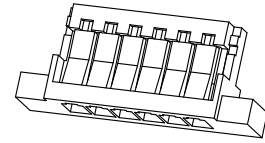
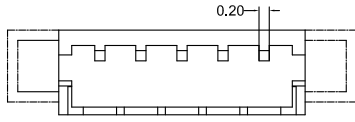

Circuit 1

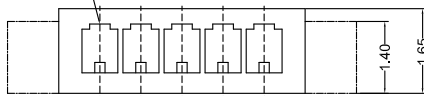

A0801HF 0XX AX P4 8 001  
 PIN  
 002=2PINS  
 SPECIAL  
 AA=NO Special  
 AB=Protrusions  
 Material  
 P4=PA46 94V-0  
 Code  
 001  
 005  
 Color  
 8=Gray

CSG PART NO.	Dimension mm		Q'ty/BAG
	A	B	
A0801HF002AXP48XXX	0.80	2.40	1000PCS
A0801HF003AXP48XXX	1.60	3.20	1000PCS
A0801HF004AXP48XXX	2.40	4.00	1000PCS
A0801HF005AXP48XXX	3.20	4.80	1000PCS
A0801HF006AXP48XXX	4.00	5.60	1000PCS
A0801HF007AXP48XXX	4.80	6.40	1000PCS
A0801HF008AXP48XXX	5.60	7.20	1000PCS
A0801HF009AXP48XXX	6.40	8.00	1000PCS
A0801HF010AXP48XXX	7.20	8.80	1000PCS
A0801HF011AXP48XXX	8.00	9.60	1000PCS
A0801HF012AXP48XXX	8.80	10.40	1000PCS
A0801HF014AXP48XXX	10.40	12.00	1000PCS
A0801HF015AXP48XXX	11.20	12.80	1000PCS
A0801HF016AXP48XXX	12.00	13.60	1000PCS
A0801HF018AXP48XXX	13.60	15.20	1000PCS
A0801HF020AXP48XXX	15.20	16.80	1000PCS

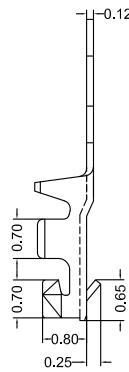
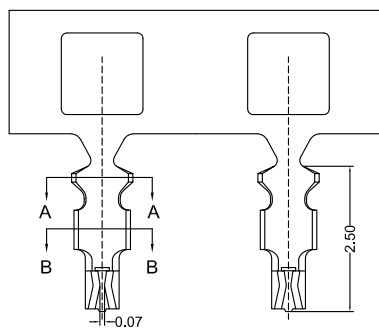

SECTION A-A



SECTION B-B

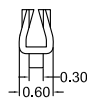

A0801 M 0 Δ XX XXX  
 Type  
 M=Female Terminal  
 Material  
 A=Phosphor  
 Finish  
 TP=TIn-Plated  
 GF=Gold-Plated G/F  
 Code  
 195  
 001

CSG PART NO.	Wire Range	Insulation O.D.	Q'ty/Reel
A0801M0ATPXXX	AWG#28-#32	0.60mm(max)	30000PCS
A0801M0AGFXXX	AWG#28-#32	0.60mm(max)	30000PCS

